

CemTie

A fully grouted remedial tie for stabilising solid masonry

Applications

- Stabilising solid or rubble filled walls
- Reinstating failed lintels (when combined with Helibeam techniques)
- Securing multi-layer brick rings in bridges, tunnels and arches
- Reconnecting separated internal and external building walls
- Securing delaminated masonry
- Repairing and securing cornices and decorative fascias
- Securing parapet walls and copings

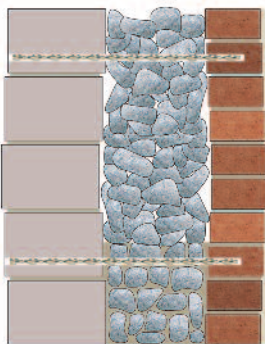

Stabilising bulging rubble-filled wall

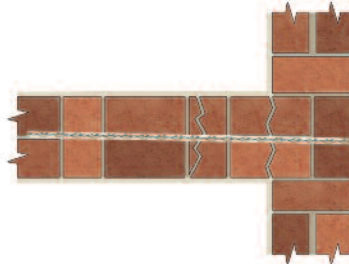

Reconnecting cracked party wall to external solid wall

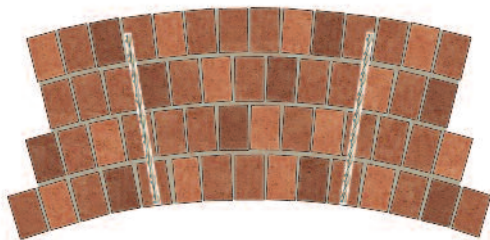

Re-pinning separated brick arch rings

Over 50 standard repair specifications are available online, covering all common structural faults.

Relevant Repair Details: CS08, CS10, CS12, CS13, LR10, MA01, RF01 to RF03, RW02, RW04, RW05



Scan the QR Code for full Product Information, Case Studies and downloadable Repair Details



Features

- Grade 316 stainless steel tie up to 1m long as standard
- Quick, easy, non-disruptive installation
- Tie and grout installed simultaneously
- Ideal for overhead installations
- Highly cost-effective masonry stabilisation technique
- Much quicker and simpler than alternative methods
- Fully concealed for sympathetic repairs
- CemTie plus HeliBond grout produces great tensile strength
- Flexible to allow normal structural movements



Inserting the grout-filled pinning nozzle, containing the CemTie, into the clearance hole

Installation Procedures

1. Drill clearance hole to required diameter and depth and thoroughly clean and wet down with water.
2. Attach the required length of CemTie pinning nozzle to the gun (see diagrams A and B below).
3. Mix HeliBond cementitious grout using a power mixer and load into the Helifix Pointing Gun HD.
4. Pump grout to fill the nozzle.
5. Wind the CemTie into the nozzle and ensure that it is fully covered in grout.
6. Insert the nozzle to the end of the drilled hole and pump the grout until the CemTie is fully embedded.

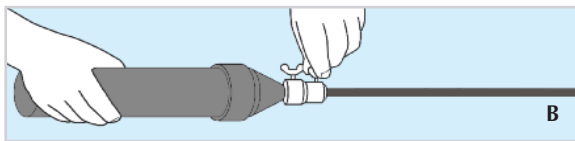
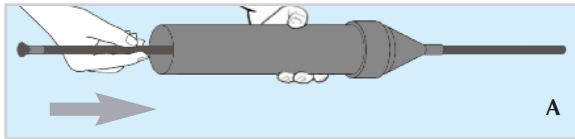

Note: CemTie pinning nozzles are available in 12.7mm and 15.0mm diameters and the length is made to suit the CemTie. The 12.7mm pinning nozzle fits the cone nozzle. The cone nozzle must be drilled out to accept the 15mm pinning nozzle.



1. Drill clearance hole to required diameter and depth and flush clean



2. Push CemTie fully into grout-filled pinning nozzle of grout gun and insert nozzle to the back of the hole



3. As grout is injected the CemTie is carried with it



4. Back pressure pushes nozzle out of hole to leave fully grouted tie

Fitting the CemTie pinning nozzle

1. Loosen the locking screws device and slide off the far end of the pinning nozzle
2. Insert the pinning nozzle tube through the cone (as in A) and secure the flared end into position at the bottom of the cone
3. Replace the locking screws device and secure to both the pinning nozzle tube and the cone (as in B)

Technical Specifications

Material:	Austenitic stainless steel grade 316 as standard (grade 304 available)
Diameter:	8mm and 10mm standard
Stock Length:	Cut lengths up to 1200mm
Required Length:	50mm less than the materials being tied
Bonding agent	HeliBond Cementitious Grout
RECOMMENDED TOOLING	
For drilling:	SDS rotary hammer drill 650/700w
For mixing HeliBond:	3-jaw-chuck drill with mixing paddle
For insertion of the CemTies:	Helifix Pointing Gun Kit HD with pinning nozzle